

1

VARIOTAST V11 main switch

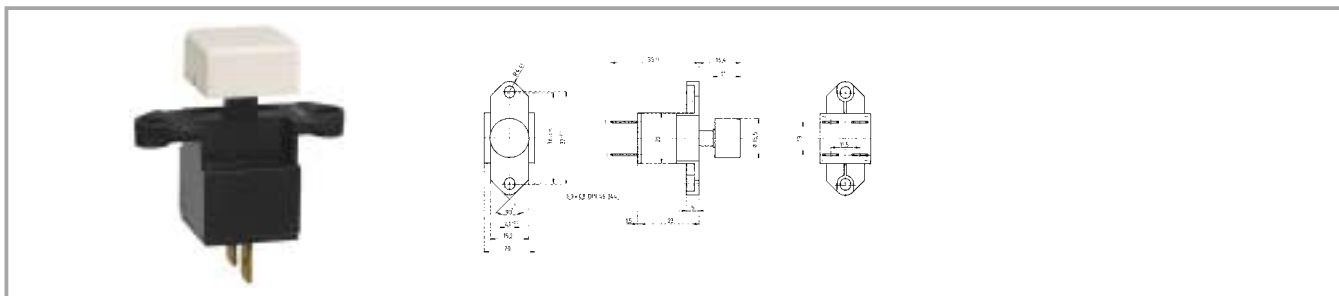

Technical data

General information

Colour of lens see keycap
Form of collar rectangular

Dimensions

Length of collar 45.5 mm
Width of collar 15.2 mm
Overall height 16.4 mm
Mounting depth 30 mm
Mounting hole 21 x 21 mm

Mechanical design

Mounting 2 x slotted hole
Terminals quick connector
6.3 x 0.8 mm
Contact system bridge contact
Contact function see order block
Contact arrangement see order block
Contact materials Ag
Illuminability no

Mechanical characteristics

Operating force max. 8 N
Operating travel 5 mm
Switching travel 2.3 mm
Robustness min. 100 N

Electrical characteristics

Rated voltage AC max. 250 V
Rated current AC max. 16 A
Contact resistance when new max. 100 mΩ

Other specifications

Operating life (operations) 10000
Degree of protection from front side IP40
Ambient temp. operating min. -25 °C
Ambient temp. operating max. 85 °C
Storage temperature min. see order block
Resistance to constant environment according to IEC 600 68-2-3 and 2-30
Resistance at variable environment according to IEC 600 68-2-14 and 2-33

Other Pushb.

Accessories VARIOTAST V11 main switch

Description	Photo	Order no.	Page
Keycap for main switch V11, round 15.5 mm, black		5.46.017.019/0103	
Keycap for main switch V11, square 19.5 mm, red		5.49.273.048/0310	

VARIOTAST V11 main switch

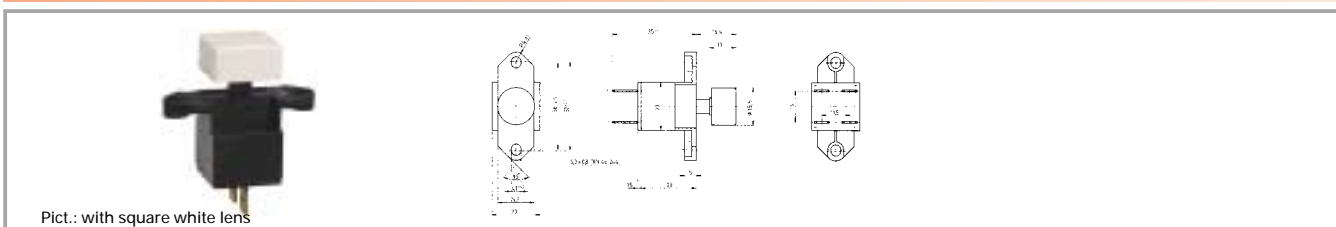

Pict.: with square white lens

Contact function	Contact arrangement	Order no. without lens	Note
latching	1 NO	2.11.160.201/0000	Please include the desired keycap separately in your order.
momentary	1 NO	2.11.100.201/0000	Please include the desired keycap separately in your order.
latching	2 NO	2.11.160.501/0000	Please include the desired keycap separately in your order.
momentary	2 NO	2.11.100.501/0000	Please include the desired keycap separately in your order.

Technical data see page 1 - 88

Accessories:

- Keycap for main switch V11, round 15.5 mm, black: 5.46.017.019/0103
- Keycap for main switch V11, round 15.5 mm, white: 5.46.017.019/0209
- Keycap for main switch V11, round 15.5 mm, red: 5.46.017.019/0310
- Keycap for main switch V11, round 15.5 mm, green: 5.46.017.019/0505
- Keycap for main switch V11, round 15.5 mm, grey: 5.46.017.019/0717
- Keycap for main switch V11, square 19.5 mm, black: 5.49.273.048/0103
- Keycap for main switch V11, square 19.5 mm, white: 5.49.273.048/0209
- Keycap for main switch V11, square 19.5 mm, red: 5.49.273.048/0310
- Keycap for main switch V11, square 19.5 mm, green: 5.49.273.048/0505
- Keycap for main switch V11, square 19.5 mm, grey: 5.49.273.048/0717

1

Other Pushb.