

1

LUMOTAST 25 keylock switch



Technical data

LUMO
25

General information

Colour of lens black opaque
Form of collar square

Dimensions

Length of collar 25 mm
Width of collar 25 mm
Overall height 32.3 mm
Mounting depth with
connector 30.7 mm
Mounting depth with
plug-in socket 33.4 mm
Mounting hole 16.2 mm

Mechanical design

Mounting ring nut
Terminals pin connector 4-pol./
plug-in socket
Contact system snap-action contact
Contact function latching
Contact arrangement 1 NO
Contact materials Au
Illuminability no
Lamp socket no
Lock cylinder lock
Wafers 8 pins
Lock type 5201
Number of locking
positions 10000
Main key yes
Symmetric key yes
Key removal position see order block

Mechanical characteristics

Operating force max. 1.5 Nm
Rotating angle 90°

Electrical characteristics

Rated voltage AC/DC max. 42 V
Rated voltage AC/DC min. 0.02 V
Rated current AC/DC max. 100 mA
Rated current AC/DC min. 0.01 mA
Contact resistance max. 100 mΩ
Bouncing time max. 5 ms

Other specifications

Operating life
(operations) 50000
Degree of protection
from front side IP65
Ambient temp. operating
min. -25 °C
Ambient temp. operating
max. +70 °C
Storage temperature min. -40 °C
Storage temperature max. +80 °C
Resistance to constant
environment according to
IEC 600 68-2-3 and 2-30
Resistance at variable
environment according to
IEC 600 68-2-14 and 2-33
Weight 20 g

Accessories LUMOTAST 25 keylock switch

| Description | Photo | Order no. | Page |
|---|-------|-------------------|--------|
| Plug-in socket for PCB | | 5.00.645.036/0000 | 5 - 28 |
| Cable (flat ribbon cable 10 cm with socket connector and male quick connector, AMP 4-pin) | | 5.03.771.306/0000 | 5 - 27 |
| Blanking cap complete with sealing disc and ring nut, square | | 5.05.800.049/0100 | 5 - 33 |



Accessories LUMOTAST 25 keylock switch

| Description | Photo | Order no. | Page |
|---|--|-------------------|--------|
| Label holder, flush, for square collar |  | 5.07.620.004/0000 | 2 - 76 |
| Flat ribbon cable, 4-wire, 1 m long |  | 5.37.700.124/0000 | 5 - 27 |
| Fixing spanner M 15, M 16 |  | 5.58.002.019/0105 | 5 - 25 |
| Spare key |  | 5.58.015.201/0000 | |
| Legend label 23 x 16 for label holder, without legend |  | 5.73.111.000/0000 | 2 - 76 |
| Socket connector, 4-pin |  | 5.92.025.368/0000 | 5 - 26 |

1

LUMO
25

LUMOTAST 25 keylock switch

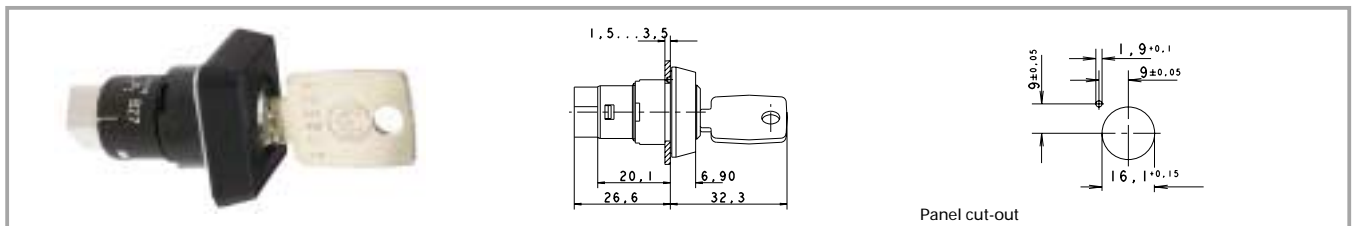

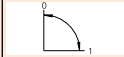
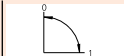
| Contact arrangement | Contact function | Rotating angle | Key removal position | Colour of lens | Order no. complete |
|---------------------|------------------|----------------|---|----------------|--------------------|
| 1 NO | latching | 90° |  | black opaque | 1.15.156.001/0000 |
| 1 NO | latching | 90° |  | black opaque | 1.15.156.011/0000 |

Technical data see page 1 - 30

Included: 2 keys.