

Signal lamps with lamp socket BA 9s (MBC/MCC), 18.2 mm

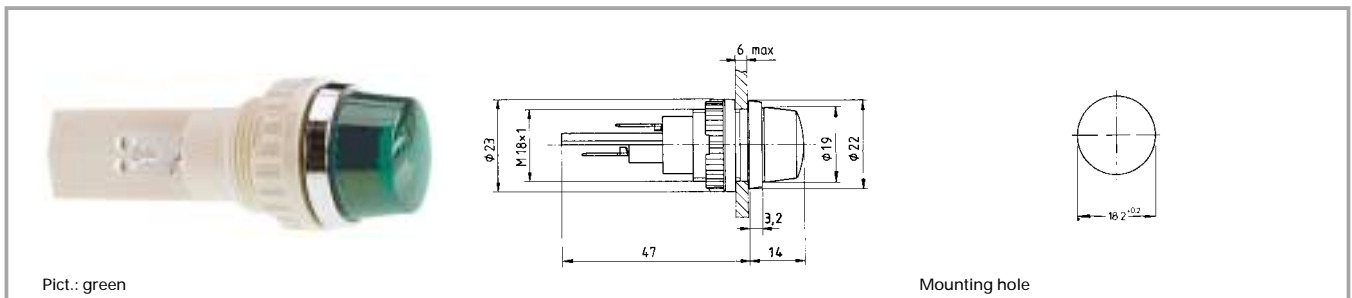

Pict.: green

Mounting hole

Technical data

General information

Form of lens round
 Colour of lens see order block
 Diameter of collar 22 mm

Electrical characteristics

Voltage limit max. 250 V
 Power limit max. 2 W

Dimensions

Overall height 14 mm
 Mounting depth 47 mm
 Mounting hole 18.2 mm

Other specifications

Degree of protection from front side IP65
 Weight 22 g
 Approvals VDE T120°C bei 2 W

Mechanical design

Mounting ring nut
 Terminals quick-connect terminals for 2x 2.8x0.8 mm tin-plated
 Lamp socket BA 9 s
 Lamp filament lamp

3

Accessories Signal lamps with lamp socket BA 9s (MBC/MCC), 18.2 mm

With Socket	Description	Photo	Order no.	Page
	Filament lamp, BA 9s base (MBC/MCC), 12 - 15 V		1.90.060.132/0000	5 - 8
	Filament lamp, BA 9s base (MBC/MCC), 24 - 30 V		1.90.060.133/0000	5 - 8
	Filament lamp, BA 9s base (MBC/MCC), 110 - 130 V		1.90.060.137/0000	5 - 8
	Protective sleeve for terminals made of Buna N (NBR)		5.52.011.027/0100	

Signal lamps with lamp socket BA 9s (MBC/MCC), 18.2 mm, round lens

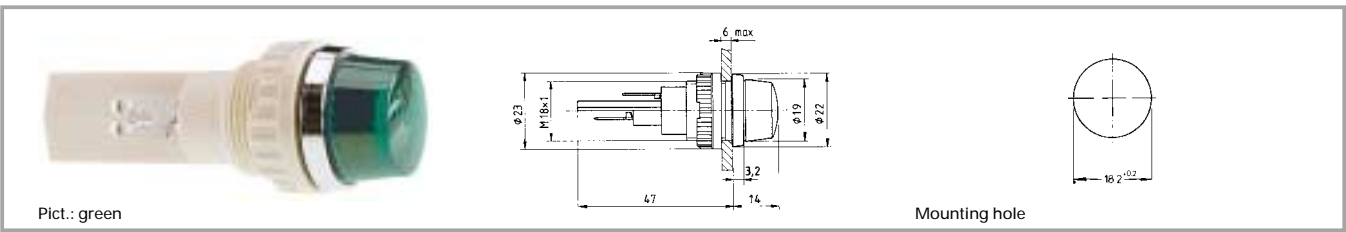

Voltage limit max.	Power limit max.	Lamp	Colour of lens	Order no. complete	Order no. single parts	
					Housing	Lens
250 V	2 W	filament lamp	transparent colourless	1.63.018.001/1002	1.63.018.091/0000	5.49.205.018/1002
250 V	2 W	filament lamp	transparent red	1.63.018.001/1301	1.63.018.091/0000	5.49.205.018/1301
250 V	2 W	filament lamp	transparent yellow	1.63.018.001/1402	1.63.018.091/0000	5.49.205.018/1402
250 V	2 W	filament lamp	transparent green	1.63.018.001/1502	1.63.018.091/0000	5.49.205.018/1502

Technical data see page 3 - 48

Please order luminous elements separately. When ordering as single parts, please add 1 x sealing ring 5.30.120.009/0100 for each signal lamp to your order.

3

With Socket