

Panel mounting sockets W 2 x 4.6d



Technical data

Mechanical design

Mounting see order block
 Terminals see order block
 Lamp socket W 2 x 4.6d

Electrical characteristics

Limit values 42 V/1.5 W

Other specifications

Weight 1 g

3

Accessories Panel mounting sockets W 2 x 4.6d

Description	Photo	Order no.	Page
Filament lamp, W 2 x 4.6d base, 24 - 30 V		1.90.120.005/0000	5 - 4
Filament lamp, W 2 x 4.6d base, 60 V		1.90.120.009/0000	5 - 4
Filament lamp, W 2 x 4.6d base, 48 V		1.90.120.010/0000	5 - 4
Filament lamp, W 2 x 4.6d base, 24 V		1.90.120.011/0000	5 - 4
Filament lamp, W 2 x 4.6d base, 6 V		1.90.120.013/0000	5 - 4
LED W 2 x 4.6d superbright, red, 24 V		1.90.690.361/0000	5 - 16
LED W 2 x 4.6d superbright, green, 24 V		1.90.690.362/0000	5 - 16
LED W 2 x 4.6d superbright, yellow, 24 V		1.90.690.363/0000	5 - 16
LED W 2 x 4.6d superbright, blue, 24 V		1.90.690.364/0000	5 - 16
		1.90.690.365/0000	5 - 16

Sockets

Panel mounting sockets W 2 x 4.6d

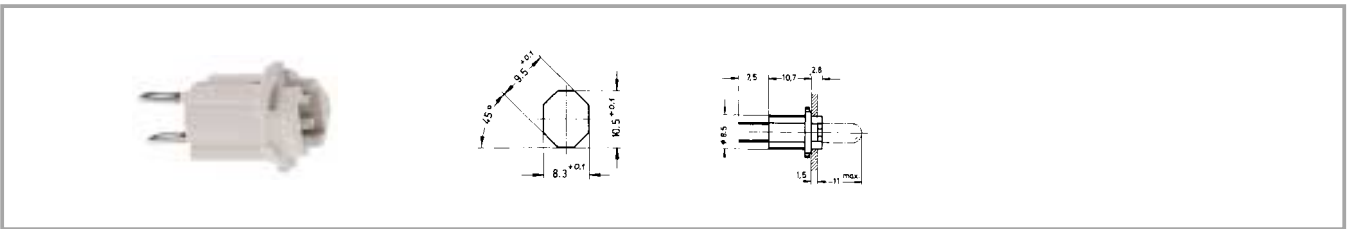

Lamp socket	Limit values	Terminals	Mounting	Order no. complete
W 2 x 4.6d	42 V/1.5 W	2 quick connectors 2.8 x 0.5	90° turn	1.72.401.001/0000

Technical data see page 3 - 60

Panel mounting sockets W 2 x 4.6d

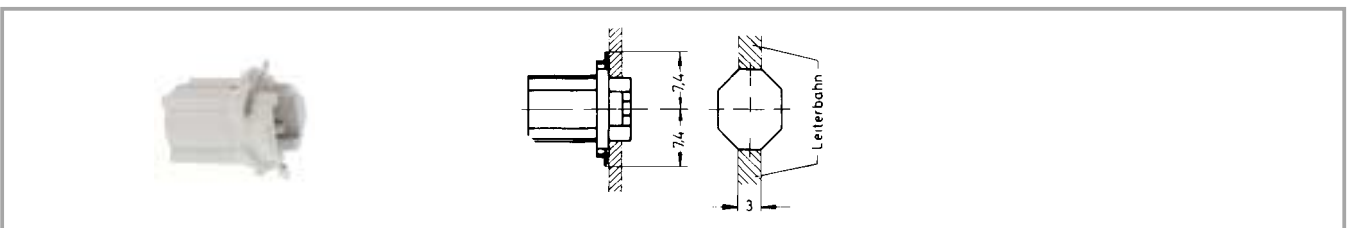

Lamp socket	Limit values	Terminals	Mounting	Order no. complete
W 2 x 4.6d	42 V/1.5 W	2 spring contacts	90° turn	1.72.401.021/0000

Technical data see page 3 - 60

3

Sockets