

**Panel mounting sockets, tubular lamp holders**



**Technical data**

**Mechanical design**

Mounting	cut-out in housing
Terminals	screw terminals
Lamp socket	S 8.5
Insulation group	according to VDE 0110 b/DIN 57110 b

**Electrical characteristics**

Limit values 2 A/42 V

**Other specifications**

Weight 11 g

3

**Accessories Panel mounting sockets, tubular lamp holders**

Description	Photo	Order no.	Page
Filament lamp, S 8.5 base, 24 V, shape L		1.90.111.003/0000	
Filament lamp, S 8.5 base, 24 V, shape K		1.90.111.103/0000	

Sockets

Panel mounting sockets, tubular lamp holders

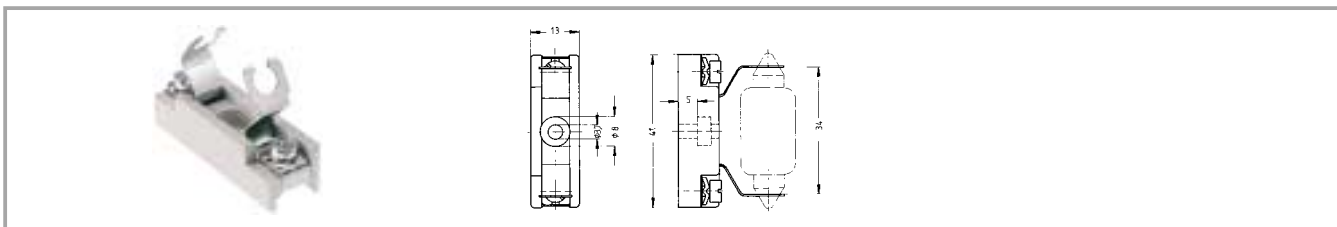

Lamp socket	Limit values	Terminals	Mounting	Order no. complete
S 8.5	2 A/42 V	screw terminals	cut-out in housing	1.02.570.021/0000

Technical data see page 3 - 62