

Multiple Level Switch LS-800E-PVC (1...4 switch points)

Max. contact loads of the reed switch: SPST 100 VA; 3 A; 250 VAC (NC/NO).
 SPDT 20 VA; 0.5 A; 250 VAC (Change-over contact).
 The data NC/NO are defined for: an empty tank / rising level.

Specifications

Materials	
Stem	PVC
Mounting elements	PVC
Float	PVC
Electrical connection	
Terminal Box (ABS) 6 pole Pg 9 cable gland with 1m PVC-cable (0.34/0.25mm ²)	
Operating Pressure	
1.0 bar	
Temperature	
-20°C ... +60°C	
Min. specific gravity of the liquid	
0.75 g/cm ³	
Depth of immersion at a density of 1	
~22mm	
Protection rating	
IP65	

Electrical connection

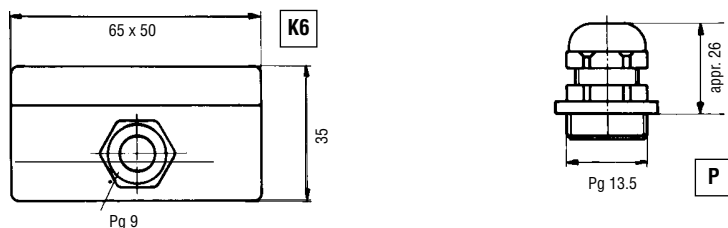

Mounting elements

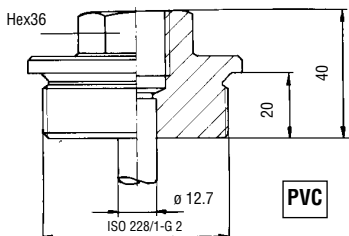

Floats

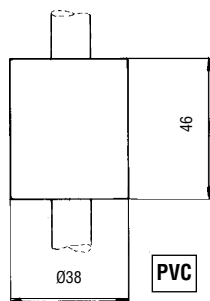

Switching groups PVC model

Group 1, max 4 switch points, NC/NO

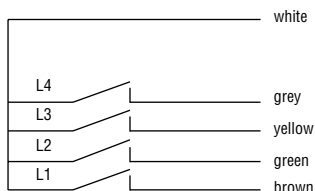

Group 3, max 2 switch points, (SPDT)

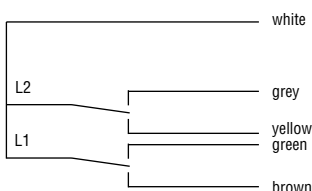

Group 2, max 3 switch points, NC/NO

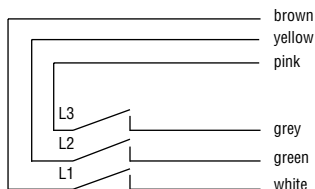

Group 4, max 2 switch points, (SPDT)

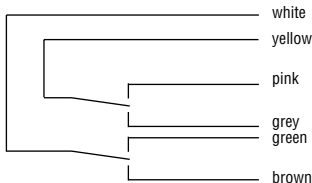

LS-800E-PVC Multiple Level Switch check list Dimensions PVC model

(Please copy and use as order form)

Customer: _____

Order no.: _____ Quantity: _____

Application specific data:
(Please complete fully and accurately)

1. Medium _____
2. Pressure (bar): Min _____ Max _____
3. Temperature (°C): Min _____ Max _____
4. Specific gravity (g/cm3): _____ Min _____ Max _____
5. Viscosity (SSU): _____
6. Tank: Material _____ Depth _____
7. Connection periphery (eg relay, PLC,.....): _____

- A = 58mm min. distance to upper switch point
- B = 50mm min. distance stem end to lowest switch point
- C = 75mm min. distance between two switch points
- D = 7mm min. distance between two switch points actuated by one float

Reference edge
(Sealing Face)

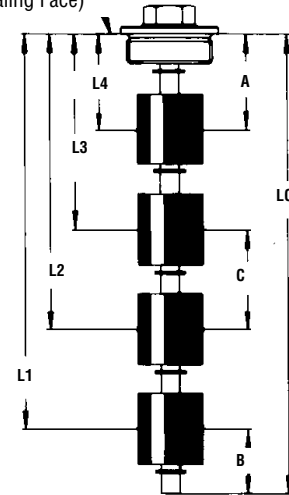

LS-800E - PVC 1. 2. 3.

Order data

1. **Mounting direction:**
 - Through tank top **0**
 - Through tank bottom **U**
2. **Electrical connection:**
 - Pg9 cable and gland (standard length: 1m) **P**
 - Terminal box 6-poles **K6**
3. **Switching:**
 - Group 1 **1**
 - Group 2 **2**
 - Group 3 **3**
 - Group 4 **4**

Dual-action:
One float actuates two
switch points
(max distance=D).

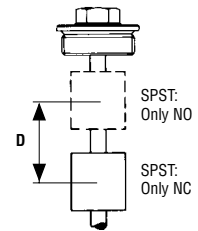

Level Dimensions (Tolerance ±3mm) related to the mid of float

Distance level	NO group 1	NC group 1	NO group 2	NC group 2	SPDT_group 3	SPDT_group 4
L1 =	<input type="checkbox"/>	<input type="checkbox"/>	<input type="checkbox"/>	<input type="checkbox"/>	<input type="checkbox"/>	<input type="checkbox"/>
L2 =	<input type="checkbox"/>	<input type="checkbox"/>	<input type="checkbox"/>	<input type="checkbox"/>	<input type="checkbox"/>	<input type="checkbox"/>
L3 =	<input type="checkbox"/>	<input type="checkbox"/>				
L4 =	<input type="checkbox"/>	<input type="checkbox"/>				
L0 =	±2mm		max 2000 mm			